

SCHEDULE OF JOINERY 1/2

P	DOORS	36" x 70"
D1	"	36" x 70"
D2	"	36" x 70"
D3	"	24" x 70"
W	WINDOWS	60" x 48"
W1	"	48" x 48"
W2	"	36" x 48"
BW	BAY WINDOWS	60" x 48"
V	VENTILATORS	24" x 24"
V1	"	48" x 30"
V1A	"	60" x 30"
V1B	"	16" x 16"
V2	"	14" x 30"

AREA DETAILS

TOTAL PLOT AREA	683.85 m ²
BASEMENT FLOOR AREA	101.70 "
GROUND FLOOR AREA	286.00 "
FIRST FLOOR AREA	279.00 "
SECOND FLOOR AREA	279.00 "
THIRD FLOOR AREA	180.00 "
TOTAL PLINTH AREA	1024.00 "

COVERAGE 3.45%
F.S.I. 1.09

COLOUR INDEX

- PROPOSALS B ———
- ROADS 0 ———
- BOUNDARY 0 ———
- EXISTINGS 0 ———

REVISED PLAN IN
DOOR NO 16 R-S NO 3754/32
BLOCK NO 74 AT
CENOTAPH I & STREET
TEYNAMPET MADRAS

PREVIOUS SANCTIONED PERMIT NO
LP NO B1 9834 192
DC 13-8-92

SCALE 1/40 80'

OWNER: *M. J.*

S. Durairaj Pandian
S. DURAIRAJ PANDIAN
S.E., A.I.E.E., P.E. Arch.
Chartered Engineer, Valuer, Industrial Consultant,
Registered Architect, Technical Engineer A
Licensed Surveyor, Corporation of Madras.
14, Sri Venkateswara Street, Alankkottai,
Madras - 600 010.
Phone: 41244
Licenses - 600 010

LICENSSED SURVEYOR

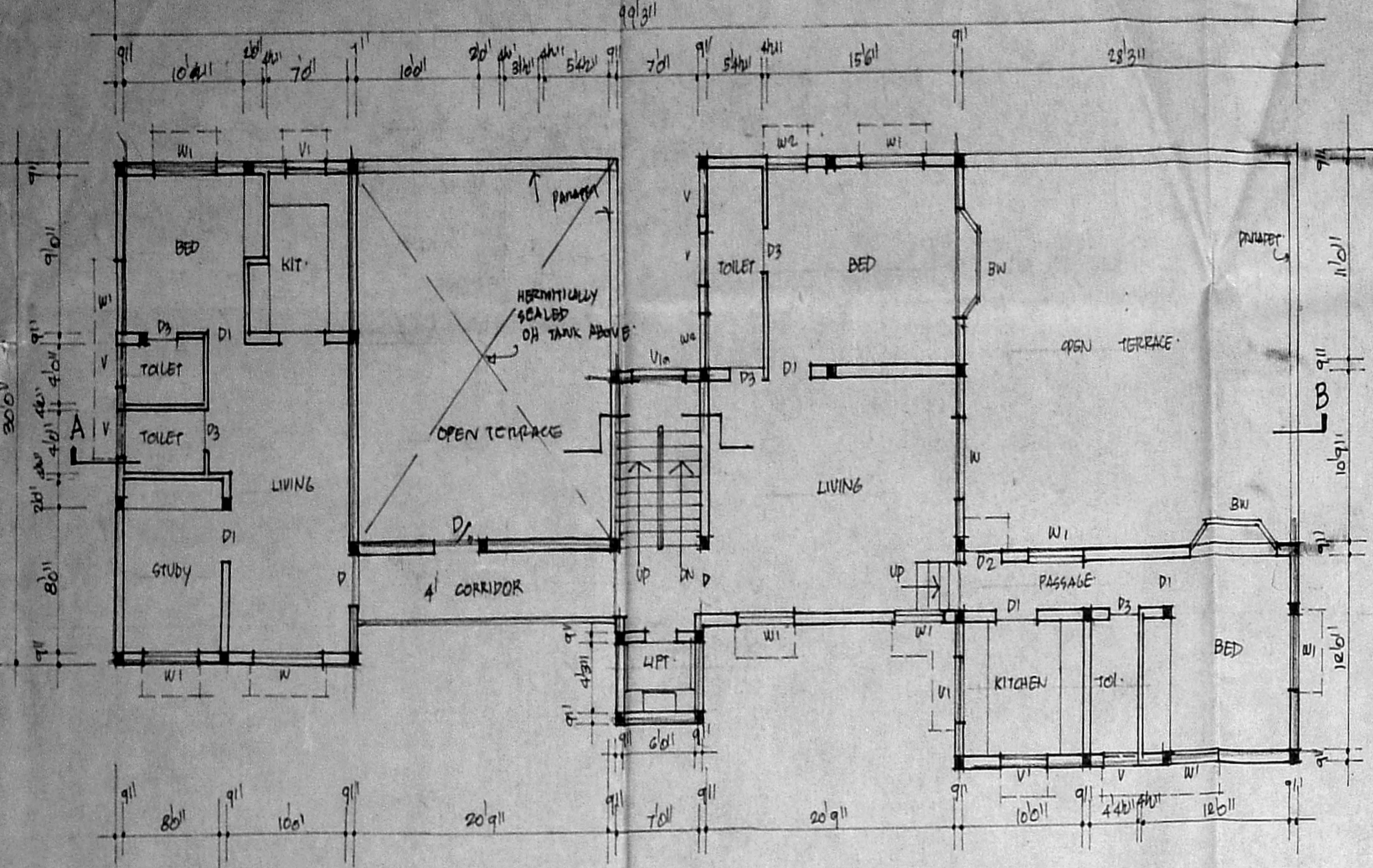

THIRD FLOOR PLAN.

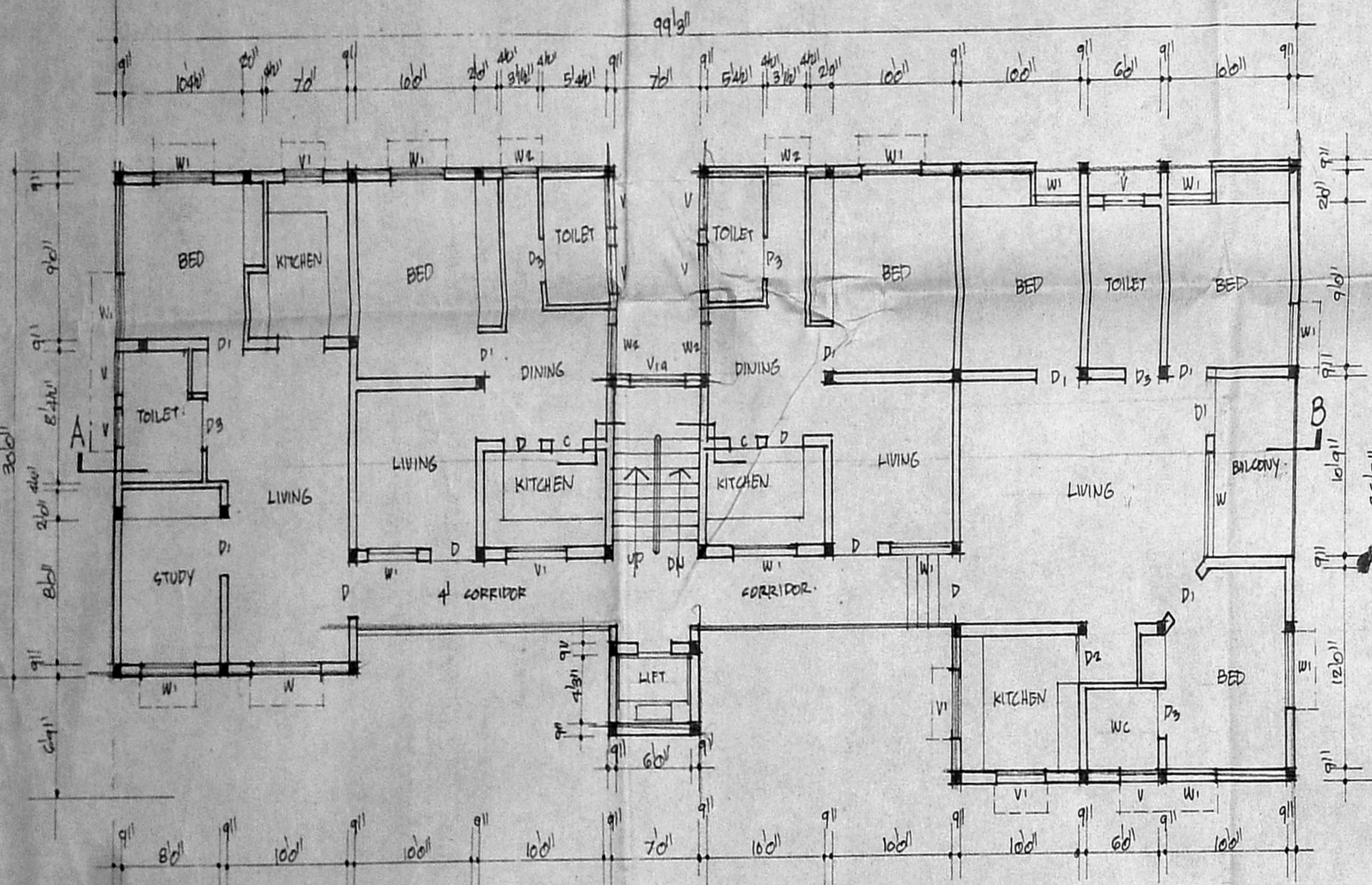

TYPICAL FIRST & SECOND FLOOR PLAN.

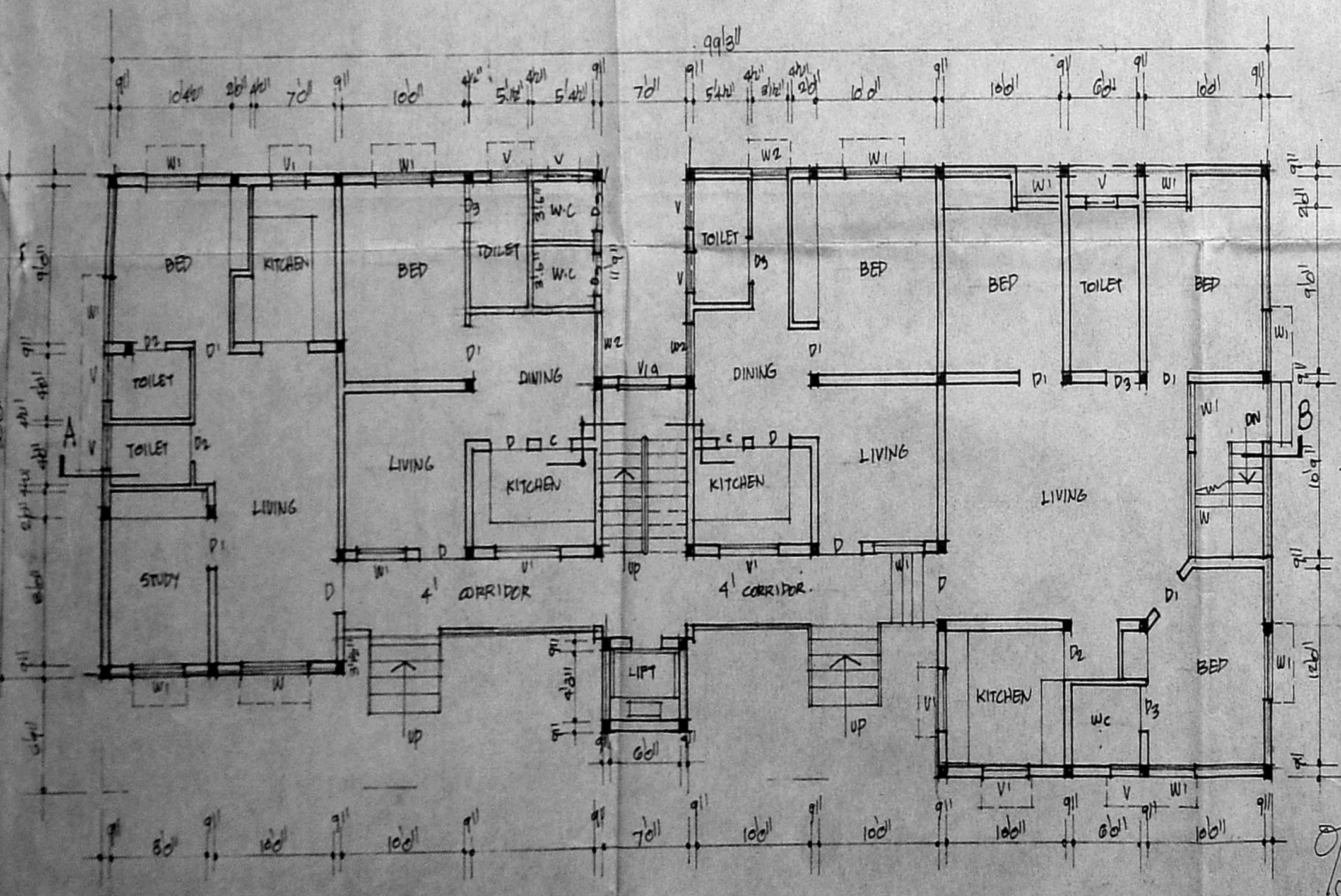

GROUND FLOOR PLAN.

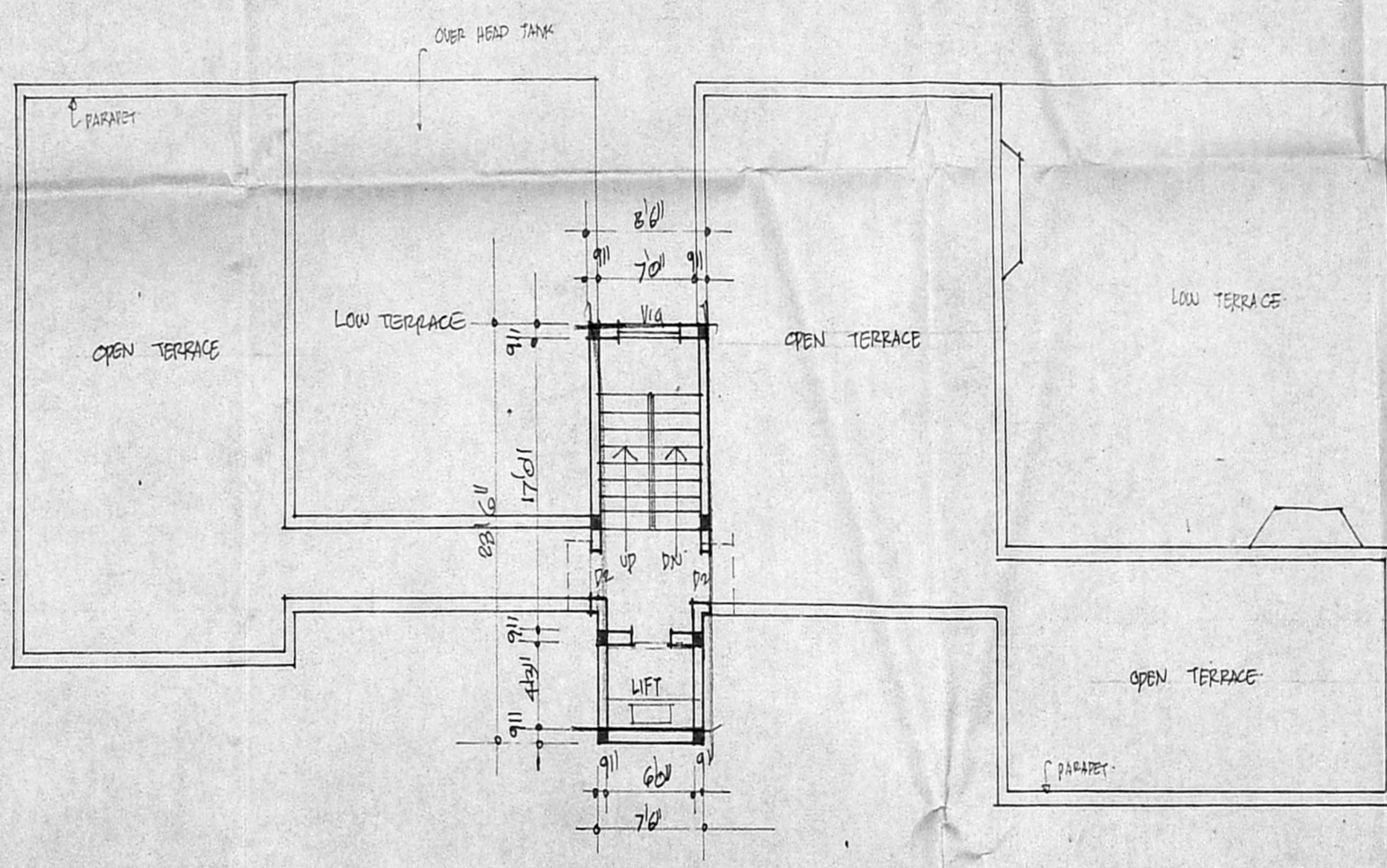

TERRACE PLAN.

B/15380/A7E/S3 R. 10/4/93

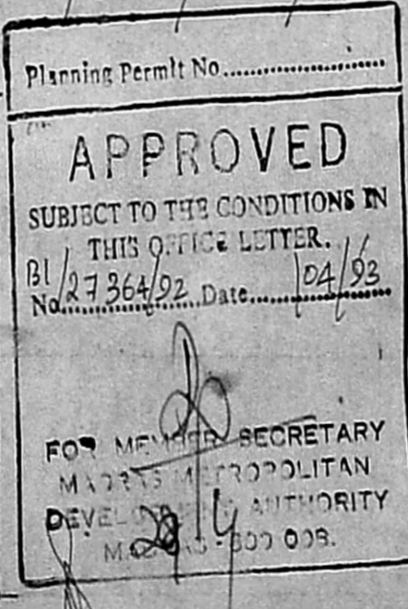

LIFT MACHINE ROOM.

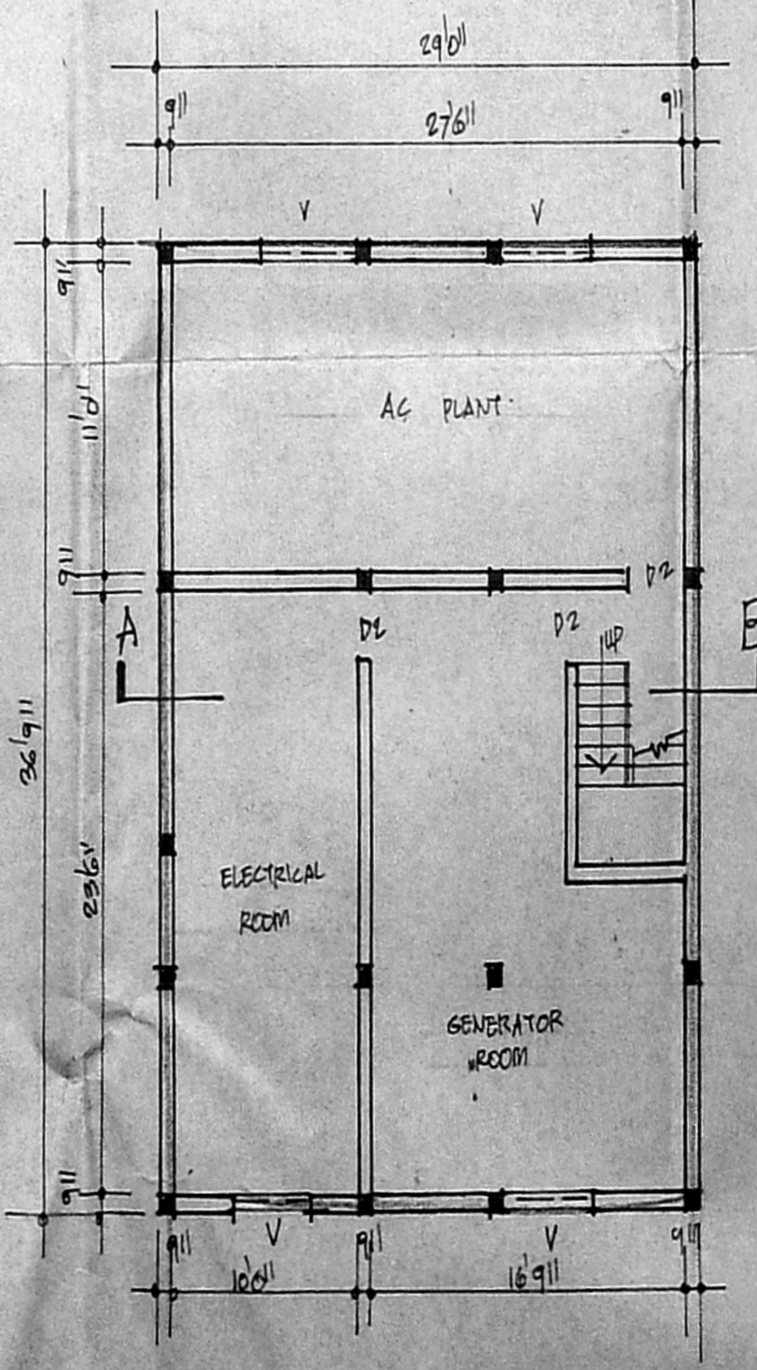

BASEMENT FLOOR PLAN.

B/15380/147 B. 02 R. 104/82

Planning Permit No.
APPROVED
 SUBJECT TO THE CONDITIONS IN
 THIS OFFICE LETTER.
 No. 27344/12 Date: 12/1/82
 FOR MEMBER SECRETARY
 MADRAS METROPOLITAN
 DEVELOPMENT AUTHORITY
 MADRAS - 600 008.

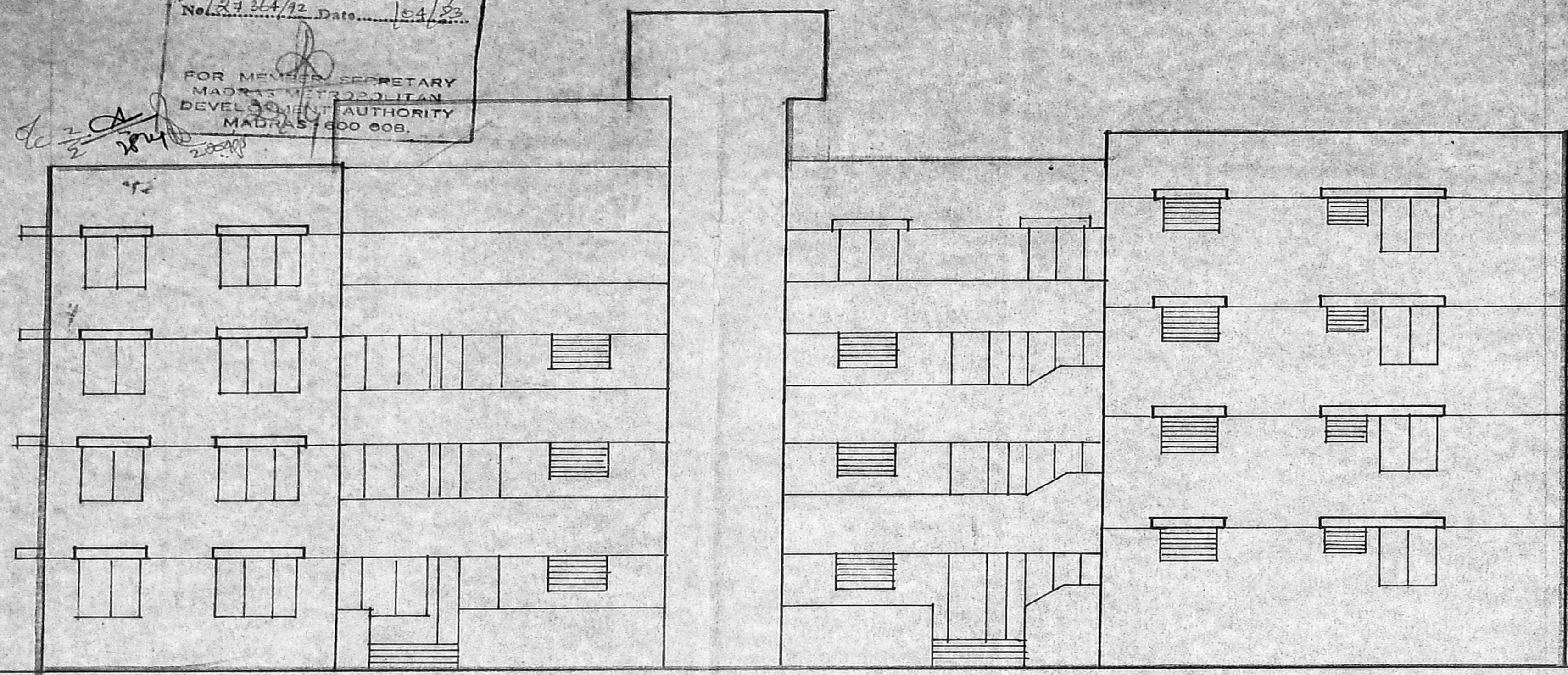

ELEVATION

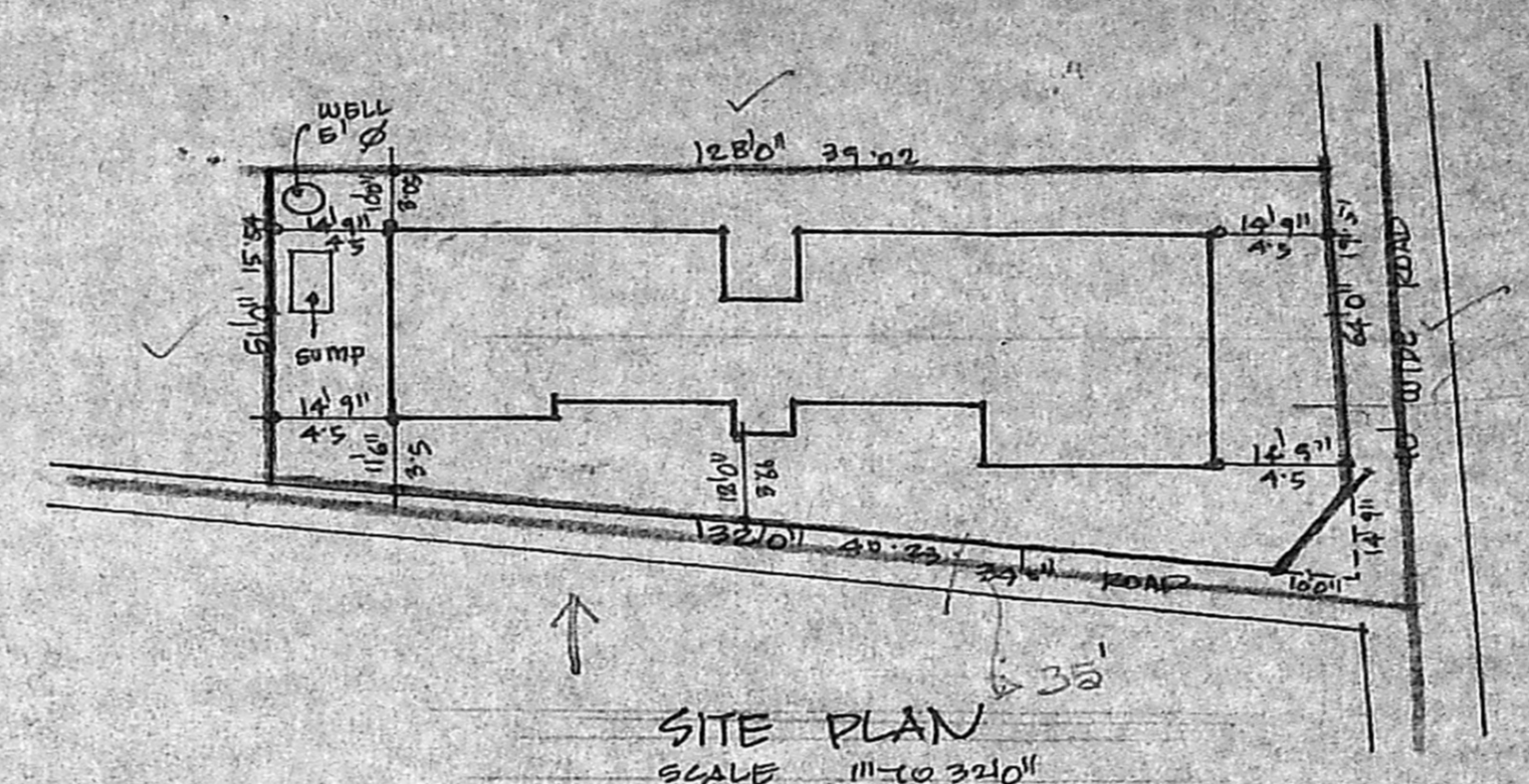

SITE PLAN
SCALE 1/16" = 1'-0"

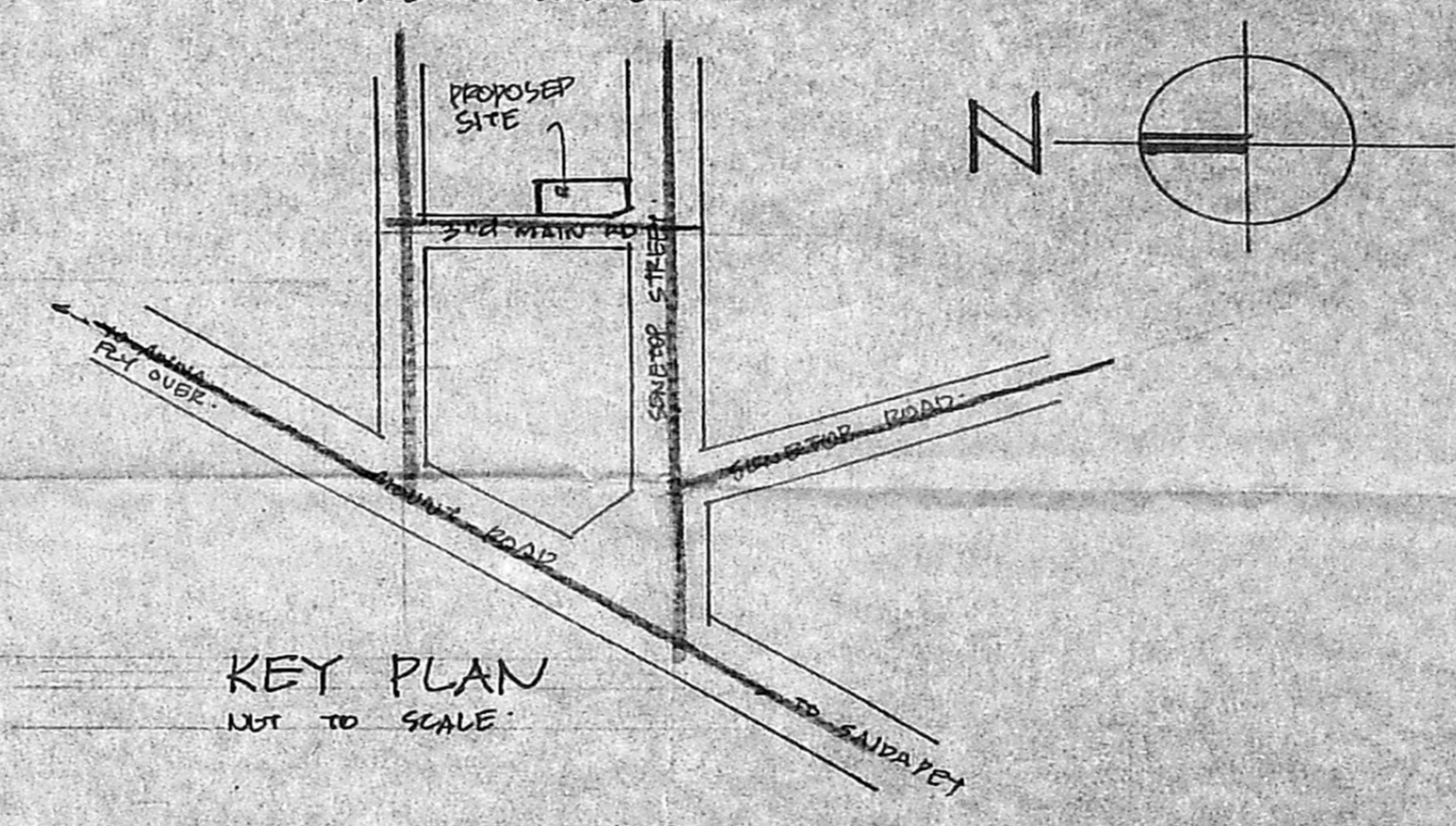

KEY PLAN
NOT TO SCALE

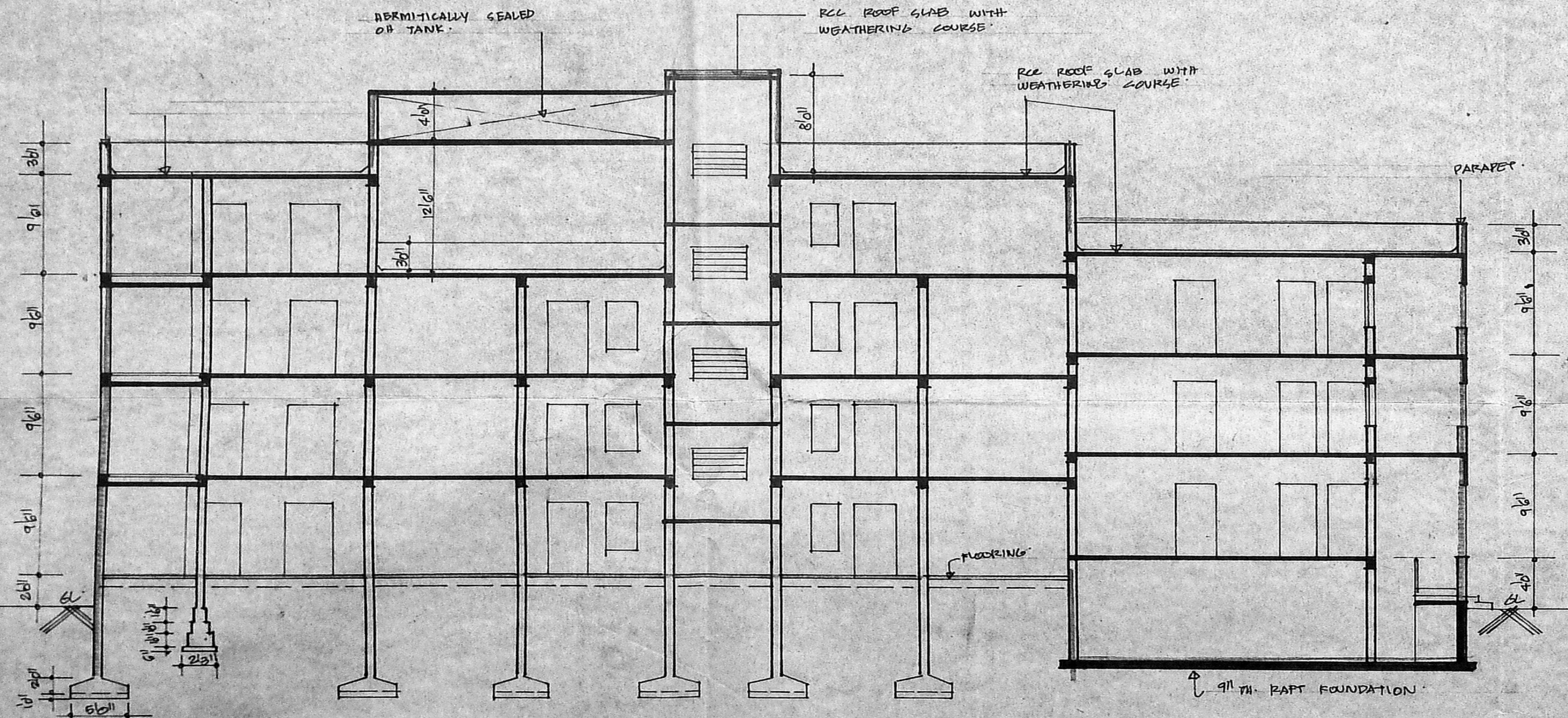

SECTION AT A-A

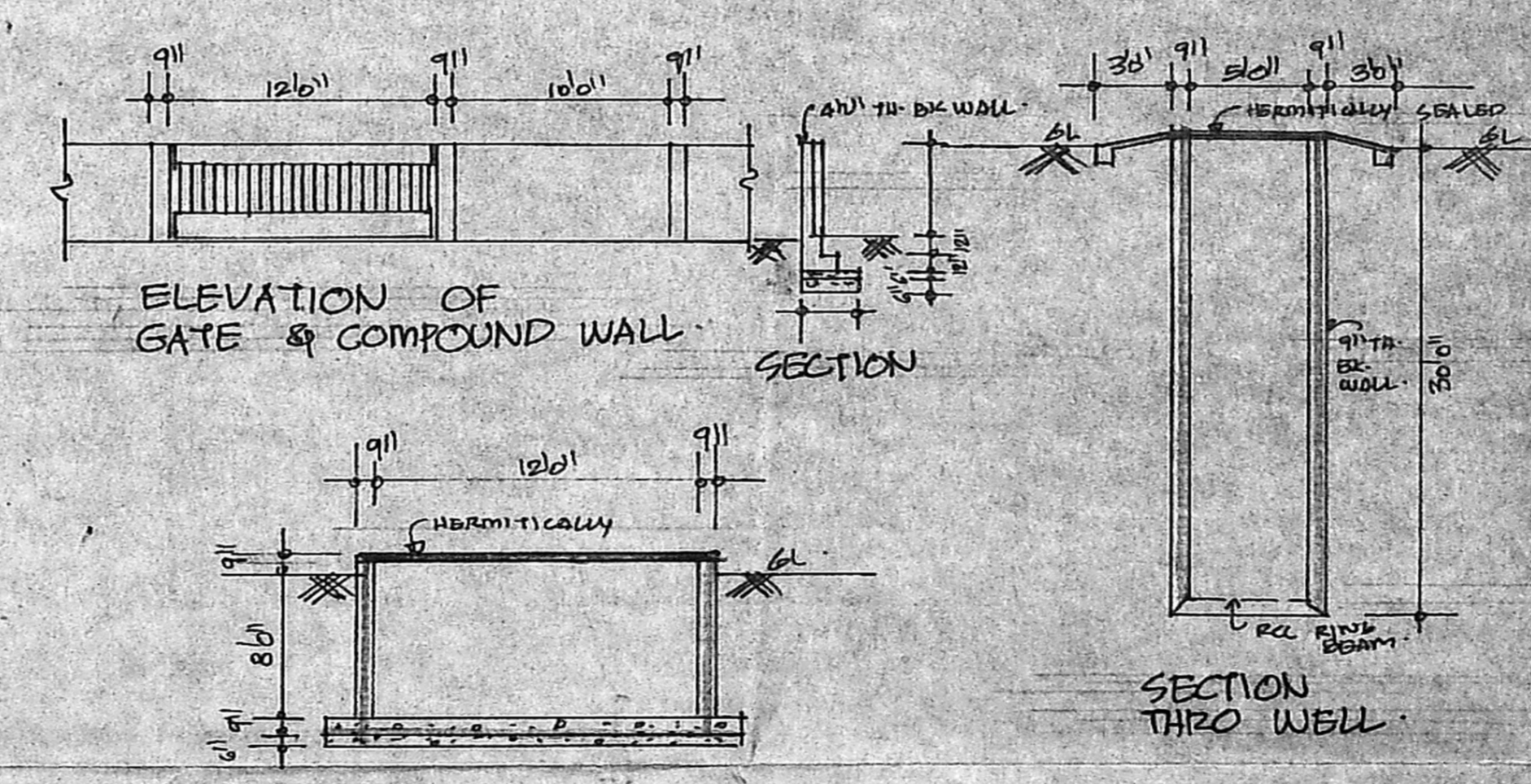

ELEVATION OF GATE & COMPOUND WALL

SECTION THRO UG SUMP

SECTION THRO WELL

SCHEDULE OF JOINERY 7/2

D	DOORS	3'6" x 7'0"
D1	"	3'6" x 7'0"
D2	"	3'6" x 7'0"
W	WINDOWS	6'0" x 4'6"
W1	"	4'6" x 4'6"
W2	"	3'6" x 4'6"
W3	"	3'6" x 4'6"
W4	"	3'6" x 4'6"
W5	"	3'6" x 4'6"
W6	"	3'6" x 4'6"
W7	"	3'6" x 4'6"
W8	"	3'6" x 4'6"
W9	"	3'6" x 4'6"
W10	"	3'6" x 4'6"
W11	"	3'6" x 4'6"
W12	"	3'6" x 4'6"
W13	"	3'6" x 4'6"
W14	"	3'6" x 4'6"
W15	"	3'6" x 4'6"
W16	"	3'6" x 4'6"
W17	"	3'6" x 4'6"
W18	"	3'6" x 4'6"
W19	"	3'6" x 4'6"
W20	"	3'6" x 4'6"
W21	"	3'6" x 4'6"
W22	"	3'6" x 4'6"
W23	"	3'6" x 4'6"
W24	"	3'6" x 4'6"
W25	"	3'6" x 4'6"
W26	"	3'6" x 4'6"
W27	"	3'6" x 4'6"
W28	"	3'6" x 4'6"
W29	"	3'6" x 4'6"
W30	"	3'6" x 4'6"
W31	"	3'6" x 4'6"
W32	"	3'6" x 4'6"
W33	"	3'6" x 4'6"
W34	"	3'6" x 4'6"
W35	"	3'6" x 4'6"
W36	"	3'6" x 4'6"
W37	"	3'6" x 4'6"
W38	"	3'6" x 4'6"
W39	"	3'6" x 4'6"
W40	"	3'6" x 4'6"
W41	"	3'6" x 4'6"
W42	"	3'6" x 4'6"
W43	"	3'6" x 4'6"
W44	"	3'6" x 4'6"
W45	"	3'6" x 4'6"
W46	"	3'6" x 4'6"
W47	"	3'6" x 4'6"
W48	"	3'6" x 4'6"
W49	"	3'6" x 4'6"
W50	"	3'6" x 4'6"
W51	"	3'6" x 4'6"
W52	"	3'6" x 4'6"
W53	"	3'6" x 4'6"
W54	"	3'6" x 4'6"
W55	"	3'6" x 4'6"
W56	"	3'6" x 4'6"
W57	"	3'6" x 4'6"
W58	"	3'6" x 4'6"
W59	"	3'6" x 4'6"
W60	"	3'6" x 4'6"
W61	"	3'6" x 4'6"
W62	"	3'6" x 4'6"
W63	"	3'6" x 4'6"
W64	"	3'6" x 4'6"
W65	"	3'6" x 4'6"
W66	"	3'6" x 4'6"
W67	"	3'6" x 4'6"
W68	"	3'6" x 4'6"
W69	"	3'6" x 4'6"
W70	"	3'6" x 4'6"
W71	"	3'6" x 4'6"
W72	"	3'6" x 4'6"
W73	"	3'6" x 4'6"
W74	"	3'6" x 4'6"
W75	"	3'6" x 4'6"
W76	"	3'6" x 4'6"
W77	"	3'6" x 4'6"
W78	"	3'6" x 4'6"
W79	"	3'6" x 4'6"
W80	"	3'6" x 4'6"
W81	"	3'6" x 4'6"
W82	"	3'6" x 4'6"
W83	"	3'6" x 4'6"
W84	"	3'6" x 4'6"
W85	"	3'6" x 4'6"
W86	"	3'6" x 4'6"
W87	"	3'6" x 4'6"
W88	"	3'6" x 4'6"
W89	"	3'6" x 4'6"
W90	"	3'6" x 4'6"
W91	"	3'6" x 4'6"
W92	"	3'6" x 4'6"
W93	"	3'6" x 4'6"
W94	"	3'6" x 4'6"
W95	"	3'6" x 4'6"
W96	"	3'6" x 4'6"
W97	"	3'6" x 4'6"
W98	"	3'6" x 4'6"
W99	"	3'6" x 4'6"
W100	"	3'6" x 4'6"

AREA DETAILS

TOTAL PLOT AREA	B
BASEMENT FLOOR AREA	C
GROUND FLOOR AREA	B
FIRST FLOOR AREA	B
SECOND FLOOR AREA	C
THIRD FLOOR AREA	C

COVERAGE :
 FSI :

COLOUR INDEX

PROPOSED	---
ROADS	---
BOUNDARY	---
EXISTINGS	---

REVISED PLAN IN
 DOOR NO 16 R.S NO 3754/82
 BLOCK NO 74 AT
 CENOTAPH I ST STREET
 JEXNAMPET MADRAS

PREVIOUS SANCTIONED PERMIT NO
 LP NO B/15380/147
 DE 12-8-82

SCALE 1/16" = 1'-0"

MM

S. DURAI PANDIAN
 S. DURAI PANDIAN
 8-B, A.M.E. BLDG. FULL ARCH.
 Chartered Engineer, Valuer, Industrial Consultant
 & Licensed Architect, Temple Road,
 LICENSURE SURVEYOR, Corporation of Madras,
 47, Sri Venkateswara Street, Chennai - 600 010,
 Kumbakonam Colony, Extn.
 MADRAS - 600 010.
 LICENSED SURVEYOR